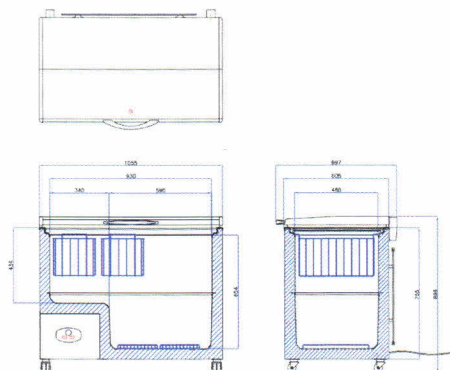

Chest freezer

SF-PC997(EX)-BF

-20°C

Thailand

Effective capacity
236L

Model		SF-PC997(EX)-BF							
Operating temperature		-20°C (ambient temperature 32°C)							
Case body	Dimensions (mm)		W	D	H	Refrigeration system	Compressor	Hermetic type	
		External	1055	697	896		Refrigerant	R134a	
	Internal	930	480	654	Evaporator		Copper tube wrapped on inner liner		
	Effective capacity (L)	236					Condenser	Wire cond & Tube natural convection	
	Outer case material	Bake on acryl finish on steel sheet					Temperature control	Mechanical thermostat	
	Inner case material	HIPS & bake on acryl finish on steel sheet					Defrost type	Manual off-cycle defrost	
	Door type	Bake on acryl finish on steel sheet				Lighting	No		
	Basket	PE powder coated basket x 2				Weight (kg)	56.5		
						Electrical parameter	Power source	Operation power	Defrost power
							1φ, 220V, 50-60Hz	ND	ND

Chest freezer

SF-PC1497(EX)-BF

-20°C

Thailand

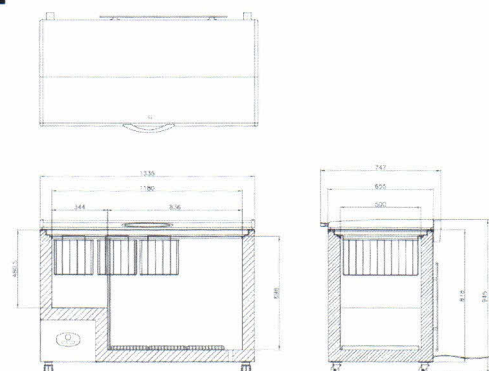
Effective capacity
357L

Model		SF-PC1497(EX)-BF							
Operating temperature		-20°C (ambient temperature 32°C)							
Case body	Dimensions (mm)		W	D	H	Refrigeration system	Compressor	Hermetic type	
		External	1335	747	945		Refrigerant	R134a	
	Internal	1180	500	698	Evaporator		Copper tube wrapped on inner liner		
	Effective capacity (L)	357					Condenser	Wire cond & Tube natural convection	
	Outer case material	Bake on acryl finish on steel sheet					Temperature control	Mechanical thermostat	
	Inner case material	HIPS & bake on acryl finish on steel sheet					Defrost type	Manual off-cycle defrost	
	Door type	Bake on acryl finish on steel sheet				Lighting	15W x 1		
	Basket	PE powder coated basket x 3				Weight (kg)	74		
						Electrical parameter	Power source	Operation power	Defrost power
							1φ, 220V, 50-60Hz	ND	ND